

# ASLP™-3.5 Proximal Medial Tibia Plate

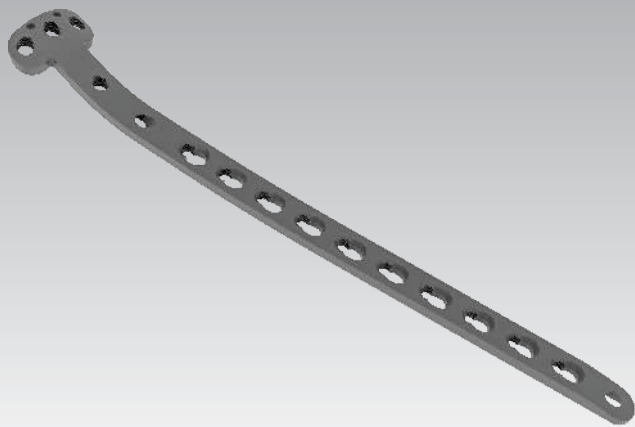

## Indication:

- Intended use to buttress support to the metaphyseal fracture of medial tibia plateau.
- Split fractures, medial split fracture & depression fractures of the medial tibia plateau.
- Treating segmental fracture of proximal tibia.
- Fixation proximal quarter of lateral / medial of the tibia.

## Features:

- Two small hole on the head are for K-wire for temporary fixation of plate on the bone and meniscal suturing.
- Anatomical precontoured design at plate head match approximately the patient's antero medial tibia bone geometry.
- Two angled hole on the shaft below the plate head holes secures and stabilize the plate position.
- Combi holes in the plate shaft accommodates 3.5 locking head screws in the threaded holes and 3.5 cortex screw in the conventional compression holes.

## ASLP – 3.5 Proximal medial tibia plate

PT097.04.01   <b>Right, 4 Holes</b>	PT097.04.02   <b>Left, 4 Holes</b>
--	---------------------------------------

PT097.06.01   <b>Right, 8 Holes</b>	PT097.06.02   <b>Left, 8 Holes</b>
--	---------------------------------------

PT097.08.01   <b>Right, 10 Holes</b>	PT097.08.02   <b>Left, 10 Holes</b>
---	--

PT097.10.01   <b>Right, 12 Holes</b>	PT097.10.02   <b>Left, 12 Holes</b>
---	--

PT097.12.01   <b>Right, 14 Holes</b>	PT097.12.02   <b>Left, 14 Holes</b>
---	--

PT097.14.01   <b>Right, 16 Holes</b>	PT097.14.02   <b>Left, 16 Holes</b>
---	--