

VALP-2.7 DISTAL TIBIA T & L-PLATE (LVM)

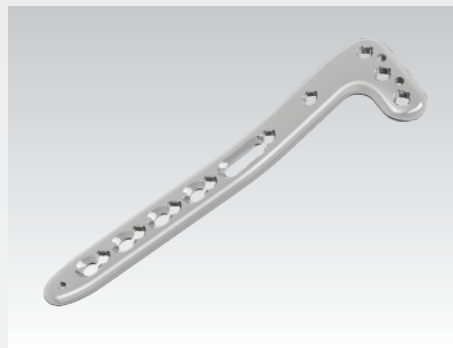

VALP-2.7 Distal Tibia L-Plate (LVM)

- | PS366.04.01 - 4 Hole Right
- | PS366.04.02 - 4 Hole Left
- | PS366.06.01 - 6 Hole Right
- | PS366.06.02 - 6 Hole Left

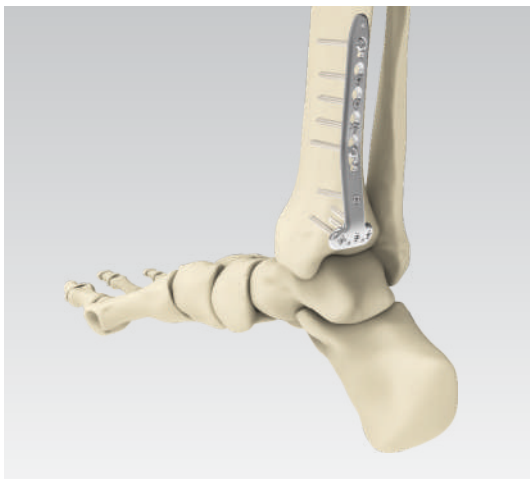

VALP-2.7 Distal Tibia T-Plate (LVM)

- | PS367.04 - 4 Hole
- | PS367.06 - 6 Hole



Ø 2.7mm Variable Angle Locking Screw (LVM)

Length 10 to 40 mm (2mm increment)
Also available in **SS210.10** to **SS210.40**
Length 45 & 50 mm
Also available in **SS210.45** & **SS210.50**

INDICATION :

- To buttress the posterior fragment of distal tibia bone.
- To buttressing the articular fracture of distal tibia.

FEATURES :

- Anatomical pre-contoured shape plate.
- Rounded edge prevent soft tissue irritation.
- Available in two variants VALP-L-plates and T-Plates.
- Accommodates the 2.7 variable angle screw.
- Available in 316 LVM material.

